

# MARELUX

## Apollo Y Strobe

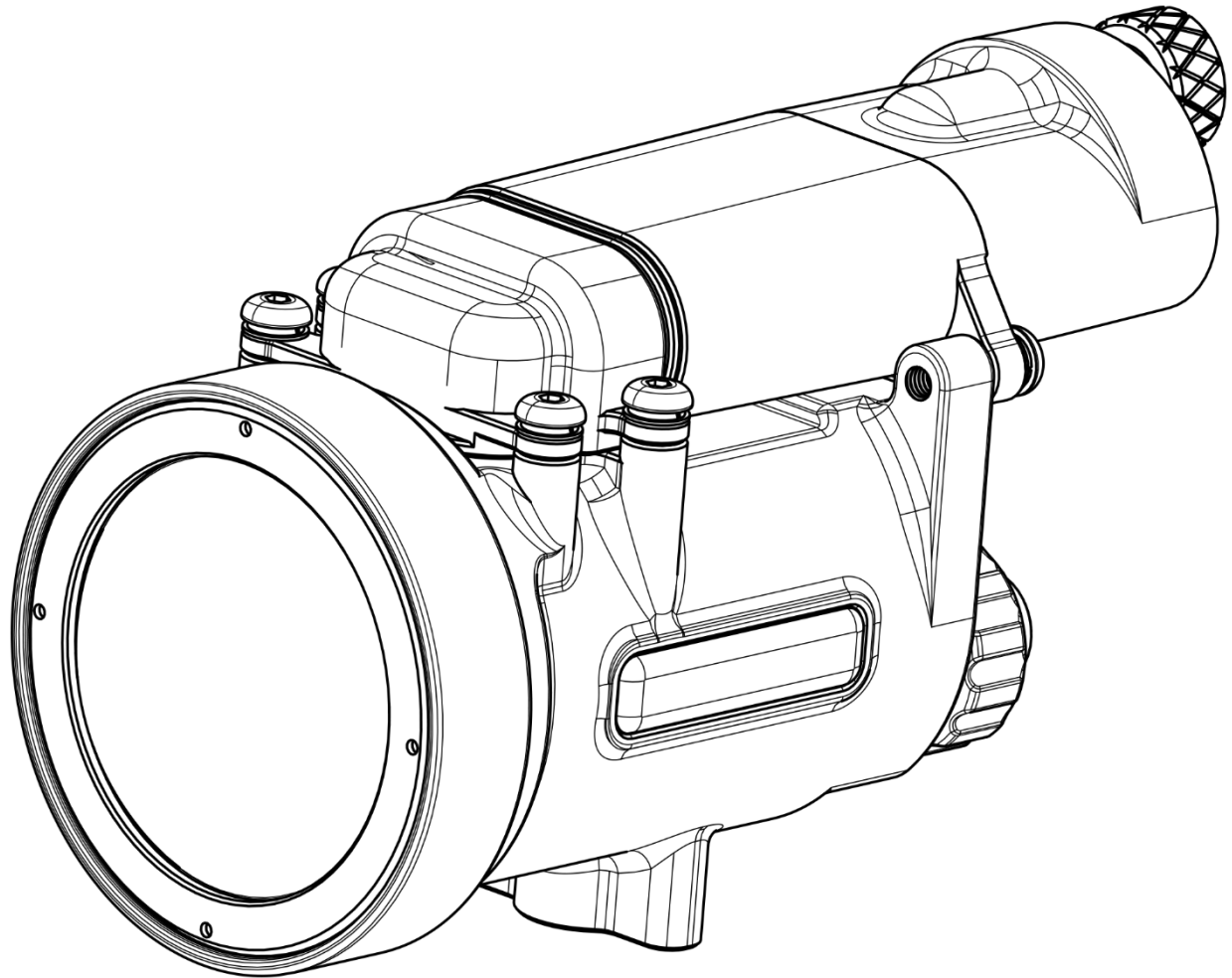

## User Manual

Please read this user manual carefully before starting to use the product, and use the product properly based on the thorough understanding of this user manual.

<https://www.marelux.co/>

# Package Contents

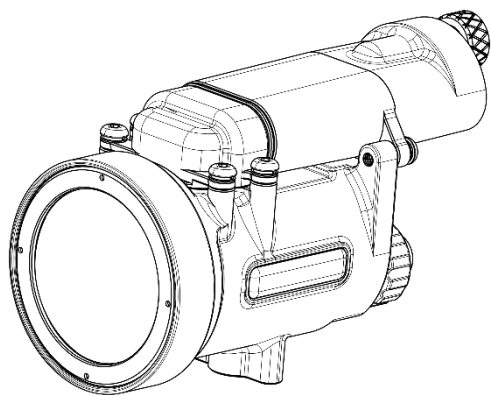

Apollo Y Strobe



Battery \*2

(Need purchase from Marelux)

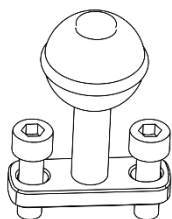

Mounting Ball



O-Ring\*2

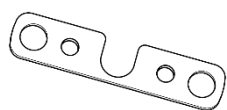

Lanyard sheet

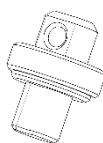

Fiber Port Plug

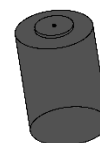

18650-21700

battery adapter \* 2

# Product Features

1. Support TTL, Olympus RC, HSS (The TTL, HSS, and RC modes require compatible flash triggers to be used)
2. With a special designed MTL mode, support continuous flashes at 10 FPS within a maximum brightness of GN9
3. Fiber Trigger: with one fiber port that supports M, Pre Flash(Compatible with compact cameras),TTL, Olympus RC(Supports RC-MANUAL, RC-TTL, RC-FP), M-HSS and MTL modes
4. Guide Number: 22 (on land)
5. Beam Angle: 120 ° ( 140 ° with Diffuser )
6. Color Temperature: 6000k (5500k with white diffuser,4700k with yellow diffuser)
7. Full Power Recycle Time: 0.6 second
8. Dimensions: max diameter 80mm, main body length 116mm, full length (including battery chamber ) 167mm
9. Weight in Air: 880g(with 2\*21700 battery),834(with 2\*18650 battery)  
Underwater weight :230g(with 2\*21700 battery),184g(with 2\*18650 battery)
10. Battery: 2x 21700 lithium batteries (Compatible to 18650 lithium batteries with adapter),MAX discharging current 15A
11. Detachable Water Proof Battery Chamber (Patented Design)
12. Full Power Flash Count: around 1500 times
13. Two Video Light Colors: 3000 lumens on white (Runtime up to 120 minutes) and 1000 lumens on red
14. Depth Rating: 100m

# Parts Illustration

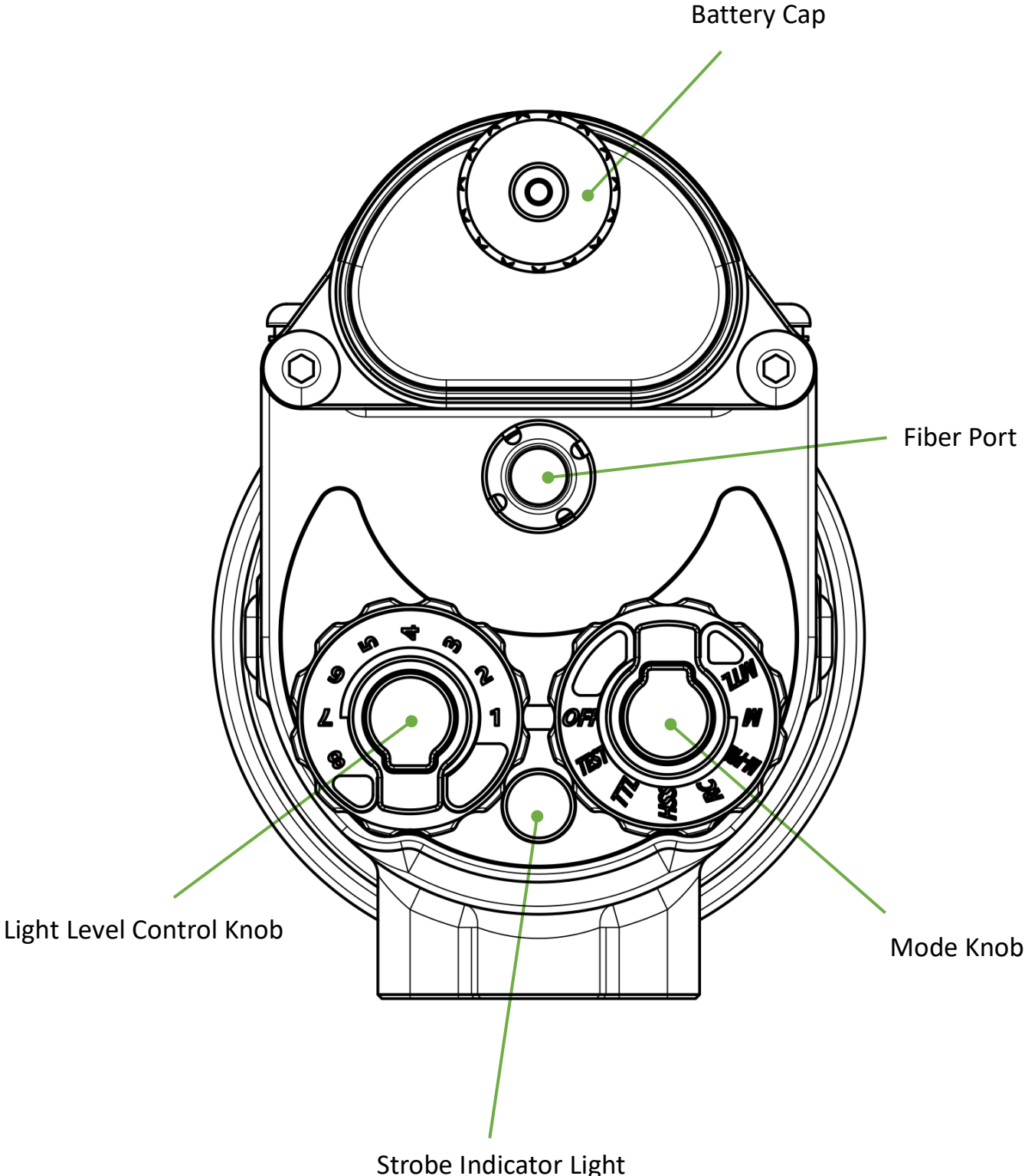

# Battery Installation

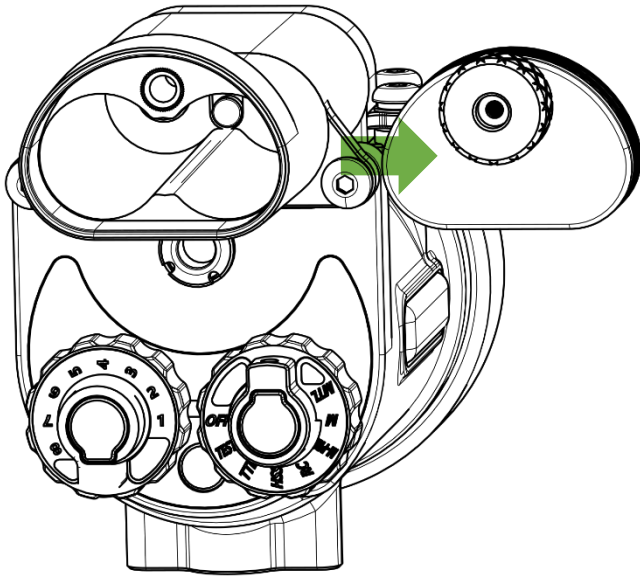

**When changing or installing the battery, make sure the mode knob is in the OFF position!**

Remove the Battery Cap by slowly rotating counterclockwise.

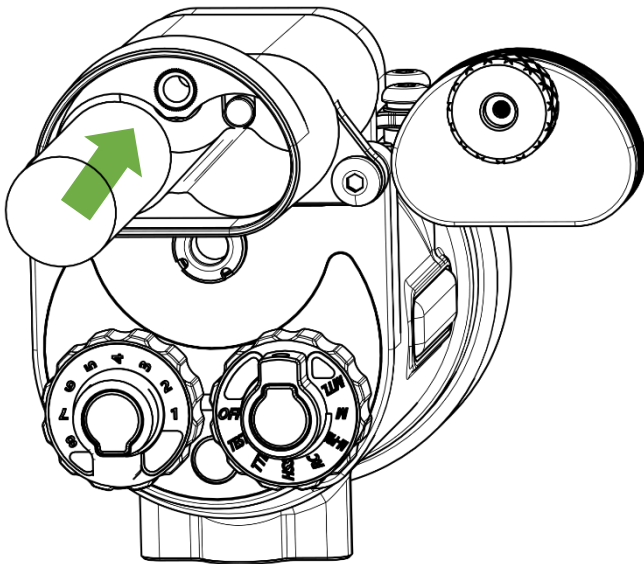

Insert two 21700 lithium batteries with the polarity shown in the battery compartment.

**(Please note that this strobe requires two 21700 lithium batteries with a discharge current greater than 20A and a voltage of 3.7V. It cannot work with regular 21700 batteries.)**

**18650 batteries can only be used with the aid of a battery adapter.**

# Operation

## Mode Knob

**OFF** Turns the power off. Switch mode knob to [OFF] when you don't use the strobe.

**TEST** In this mode, you can test the working status of the strobe. Press the mode knob to trigger the strobe.

**TTL** Switch to TTL mode when shooting with TTL flash output. (This mode requires a flash trigger that supports TTL mode to use)

**HSS** Switch the HSS mode when shooting with high-speed synchronization. (This mode requires a flash trigger that supports HSS mode to use)

**RC** Switch to RC mode to use Olympus RC shooting – compatible with RC-MANUAL, RC-TTL, RC-FP

**PRE-M** Switch to PRE-M mode when performing flash triggering shooting with a compact camera with pre-flash (e.g., Olympus TG series, Sony RX100 series)

**M** Switch to M mode to set light amount to Manual.

**(Warning ! Use M model power level 12, for high-speed continuous shooting over 100 times, may cause aging of the coating on dome, and deformation of internal structure. Please don't use M mode for high frequency continuous shooting. And only use strobe underwater !)**  
**(Warning! In M-HSS mode, please do not take more than 30 continuous shots within one minute !)**

**MTL** Switch to MTL mode when shooting in continuous mode. When using the strobe in MTL mode with fiber connection, it supports 10 continuous shots per second at all power settings.

**Do not use the MTL mode for continuous shooting when the battery level is at half or below!**

**When the strobe is in operation, press the MODE knob to activate the video light in any mode except TEST mode. The video light can switch between red and white, with two brightness levels (low and high) available for each color.**

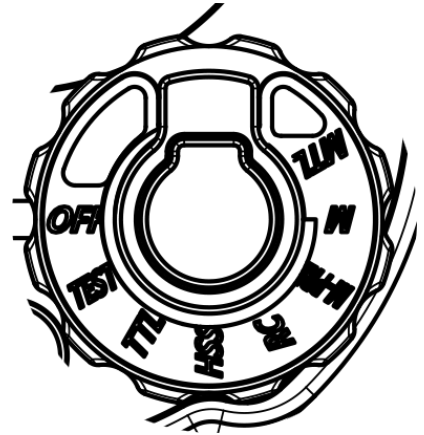

## Strobe Indicator Light

The emission color of the strobe indicator light will change depending on the remaining battery level. Emission colors are shown in the table below.

<i>Remaining Battery Level</i>	<i>Emission color</i>
80~100%	Blue
60~80%	Green
40~60%	Yellow
20~40%	Purple
0~20%	Red

When the strobe indicator light is in a low battery state with a red light, please refrain from using the flash function to avoid damaging the battery.

The strobe will preheat for 10 seconds when first turned on, during which the strobe indicator light will remain red. Please wait for the preheating to finish before using the strobe.

When the strobe overheats, it will trigger an overheat protection mechanism, preventing further flash triggering. The strobe indicator light will become yellow, indicating the need for cooling for a few minutes.

## Light Level Control Knob

Light amount can be adjusted in 12 increments:

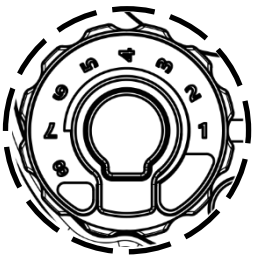

### *M Mode*

<i>Level</i>	1	2	3	4	5	6	7	8
<i>GN</i>	1.0	2.8	4	5.6	8.0	11	13.5	22

### *MTL Mode*

<i>Level</i>	1	2	3	4	5	6	7	8
<i>GN</i>	1.0	2.8	4	5.6	7	8	9	10.5

**Press light level control knob: Switch video light auto switch-off time (0.2s/1.2s available)**

# Mounting Ball Installation

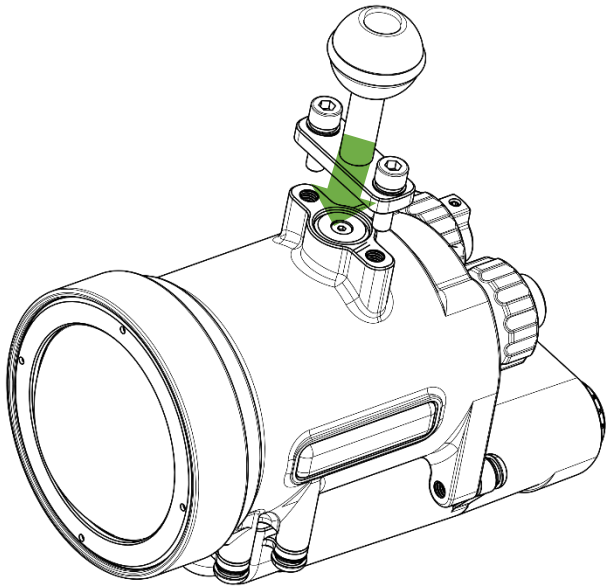

Install the mounting ball with two screws in the direction shown in the diagram.

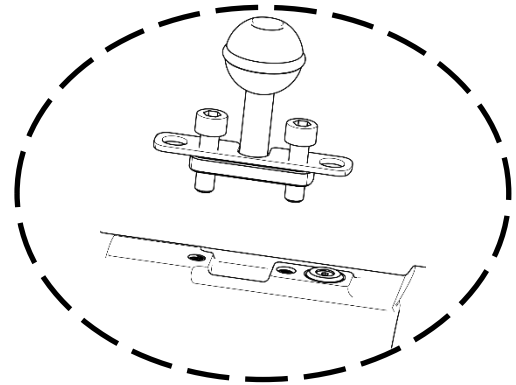

Install the lanyard sheet with two screws in the direction shown in the diagram.

# Dome Diffuser Installation

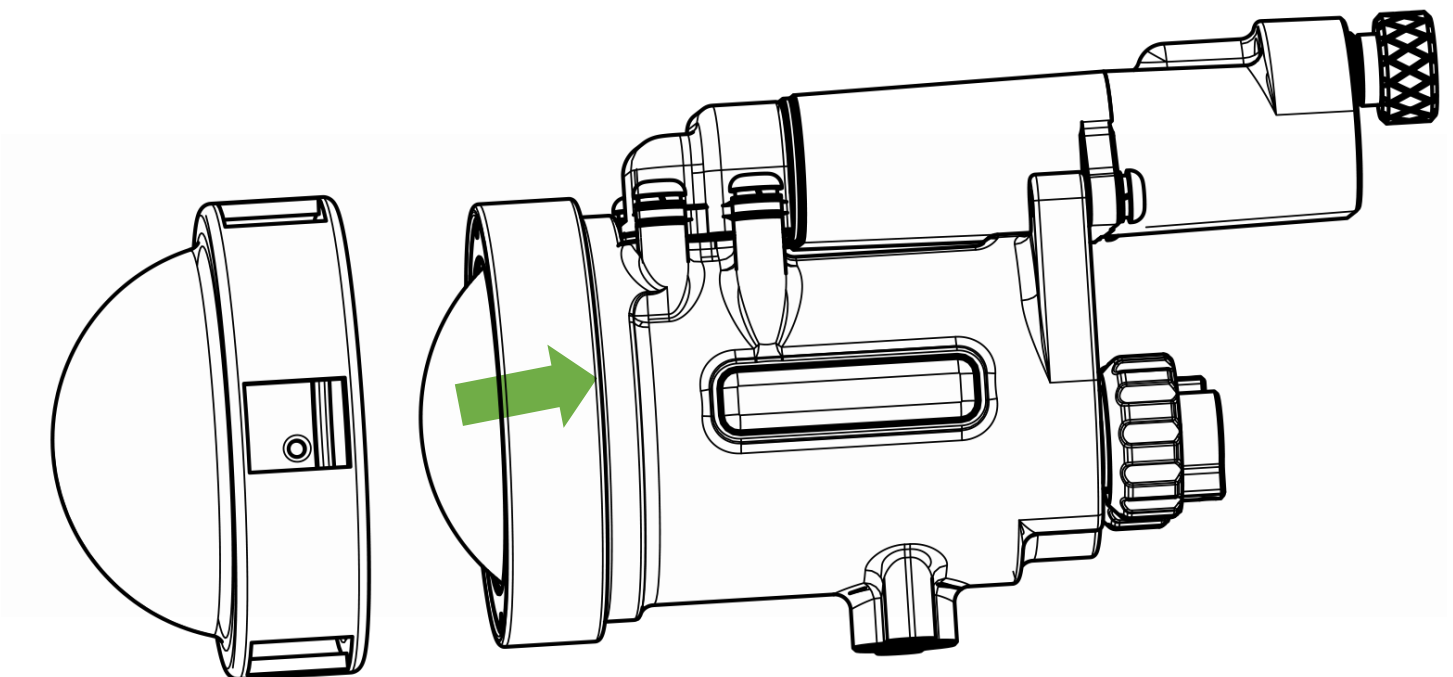

Install the diffuser in the direction shown in the figure

# Maintenance And Storage

1. After diving, make sure the strobe is locked and sealed, wash the strobe body with fresh water.
2. When immersed with fresh water, push each button few times, thus can help to let salt and sand go out.
3. Use a soft cloth to wipe and clean the glass on the dome.
4. After each dive, clean the O-rings and check if there are damages on the O-rings.
5. Use sturdy and shock-proof case to carry the strobe and its accessories.
6. Don't leave the strobe for too long inside vehicle under exposure to sunlight or heat.
7. Please stop charging the battery when it is full to prevent overcharging and damage to the battery.
8. If don't use the strobe for long period, remove the batteries.
9. This product is prohibited for use or play by children under 10 years old.

# Warranty

1. Marelux provides 2 years warranty for its housing body, cable (such as fiber cable and HDMI cable), and 1 year warranty for electronic parts and components made of silicon, rubber and plastic.
2. Marelux will keep components and parts for repair and maintenance in storage for 5 years after EOL of each model. Beyond this period, Marelux may not be able to provide repair service for those products.
3. Repair caused by following reasons will still be charged by marelux even during the 2 years warranty.
  - Damage from misuse, incorrect maintenance or storage not complying with the specifications and notices in this users' manual;
  - Damage from falling or inappropriate placement of the product;
  - Damage caused by repair, maintenance, dismantlement, modification or cleaning by any unauthorized vendor or service center by Marelux;
  - Product without authentic Marelux serial number, or with erased, distorted or falsified serial number;
  - Damage caused by usage of non Marelux recommended accessories, parts, components from other makers or suppliers, such as Flash Trigger, Cable, Dome Port, Extension Ring, Convertor and etc;
  - Damage caused by misuse or mistreatment by human, or by natural disaster or other situations of force majeure;
  - Malfunction or damage caused by erosion due to not cleaning the housing or accessories.
4. Batteries, lubricants and other consumable supplies are not in warranty.
5. All parts and components replaced from the housing and its accessories in the warranty service should belong to Marelux.
6. Marelux is not responsible for and will not compensate any collateral damages or financial losses caused by using Marelux products, such as income or fees related to the users of Marelux products.

- Warranty is only provided to products sold inside the service territory of the distributor or reseller.
- Products purchased and used for rental business are not included in warranty.
- Products will lose warranty immediately after unauthorized repair or modification.
- The warranty terms above are made for Marelux customers to conduct free warranty service and repair and have no restriction to any legal rights that customers shall possess.